

INSTALLATION OF DUMB WAITER DIRECT SUSPENSION LIFT

A. METAL SHAFT CONSTRUCTION

Step 1

Mark and drill the floor to fix the shoes of the metal shaft on the ground with M12 bolts. Next, assemble the horizontal beams, as shown in the next picture.

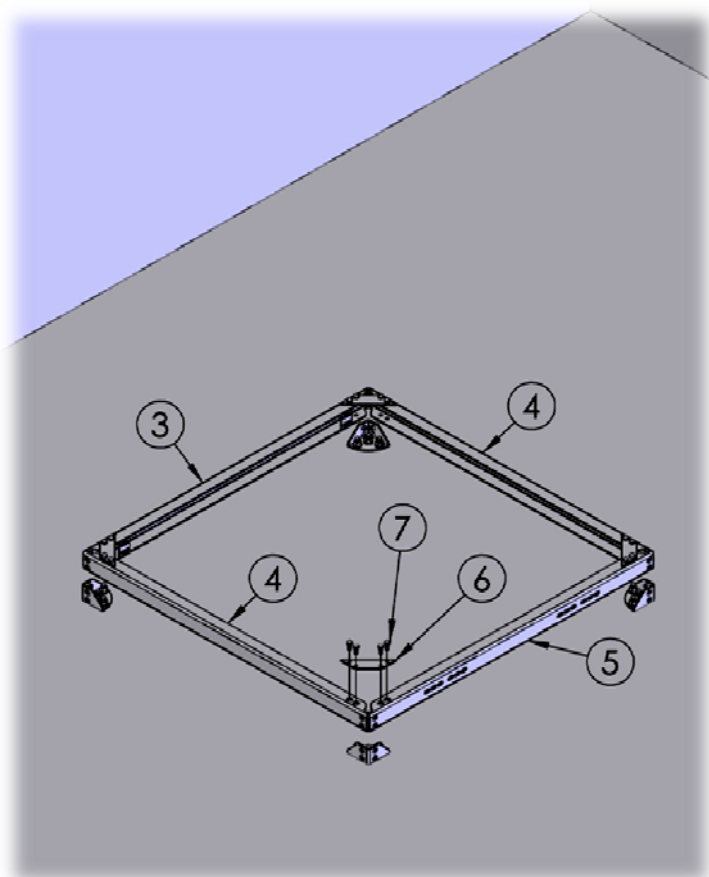
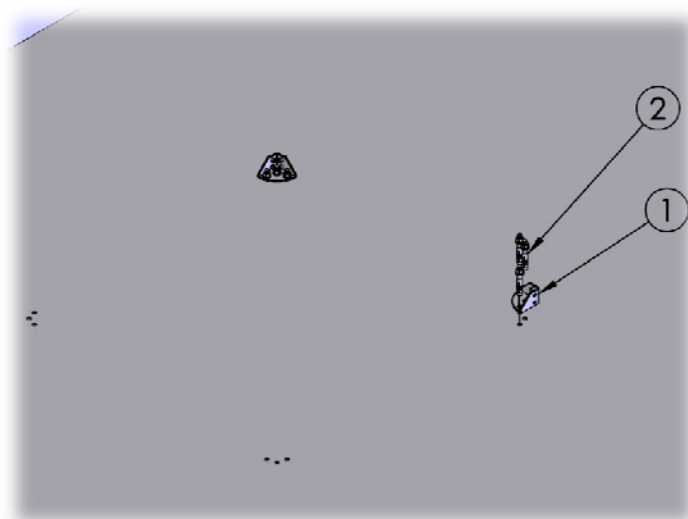

1.	SHAFT SHOE
2.	M12 BOLT
3.	HORIZONTAL DOOR BEAM
4.	HORIZONTAL BEAM
5.	HORIZONTAL BRACKET BEAM
6.	SUPPORT
7.	M8x25 BOLT

Step 2

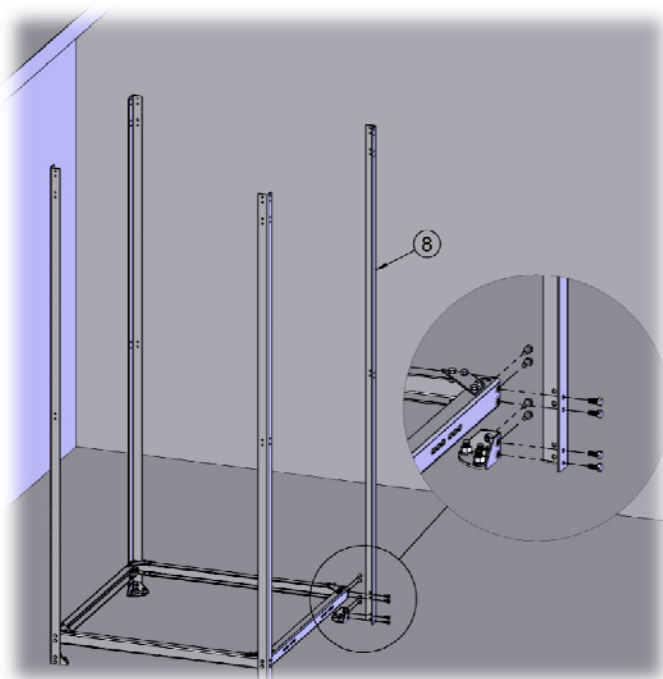

Assemble the horizontal to the vertical beams and the shoes, as shown to the side picture. Next, add the rest of the horizontal beams to make the whole construction more robust.

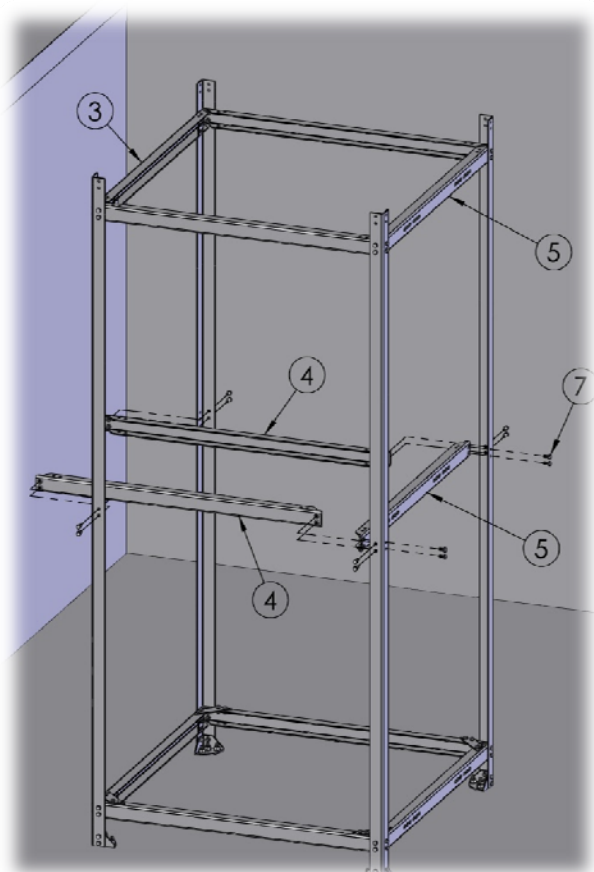

1.	SHAFT SHOE
2.	M12 BOLT
3.	HORIZONTAL DOOR BEAM
4.	HORIZONTAL BEAM
5.	HORIZONTAL BRACKET BEAM
6.	SUPPORT
7.	M8x25 BOLT
8.	VERTICAL SHAFT BEAM

Step 3

Next, assemble the upper vertical beams with corner flanges and M8X25 bolts. Finish the assembling of the shaft by repeating step 2 for the horizontal beam installation.

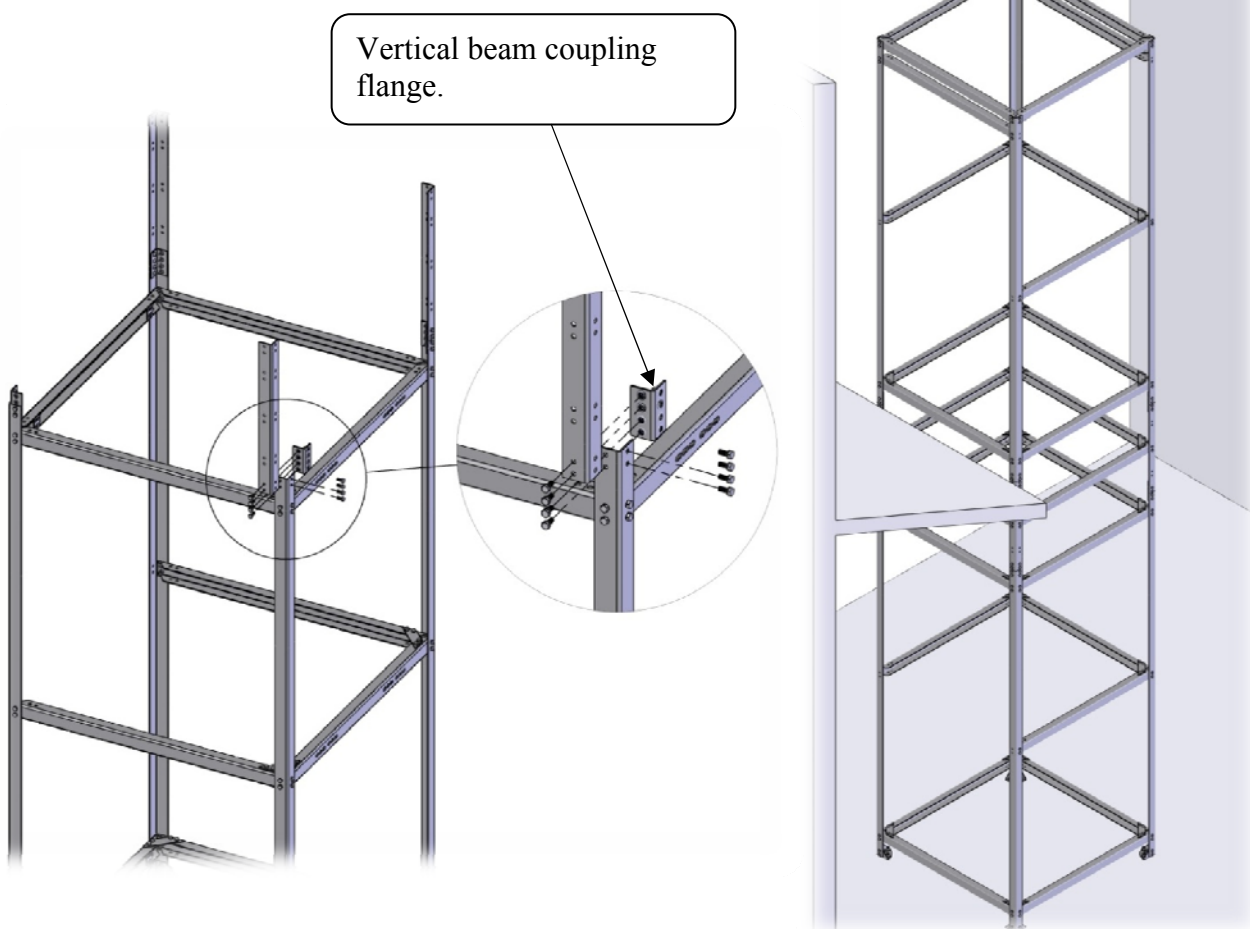

B. GUIDES INSTALLATION**Step 1**

Mount the wall brackets onto a metal or cement shaft, as shown at the following pictures.

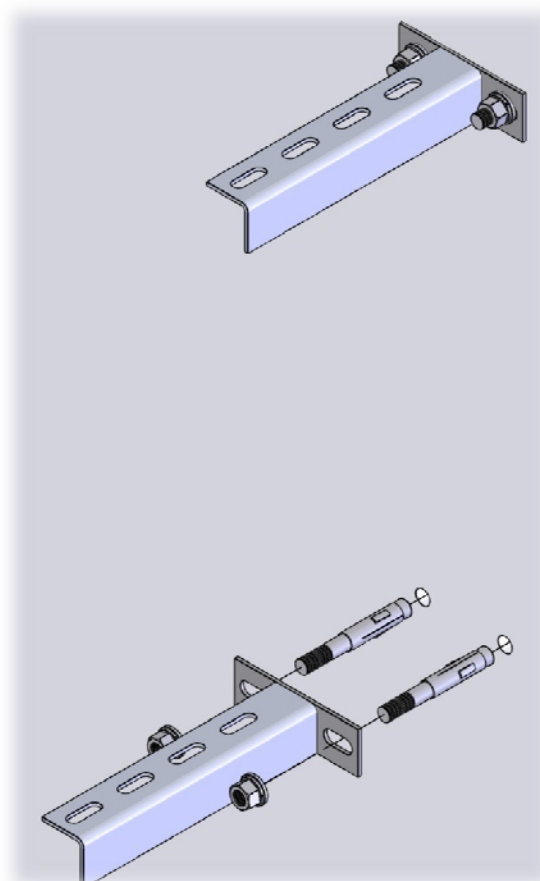
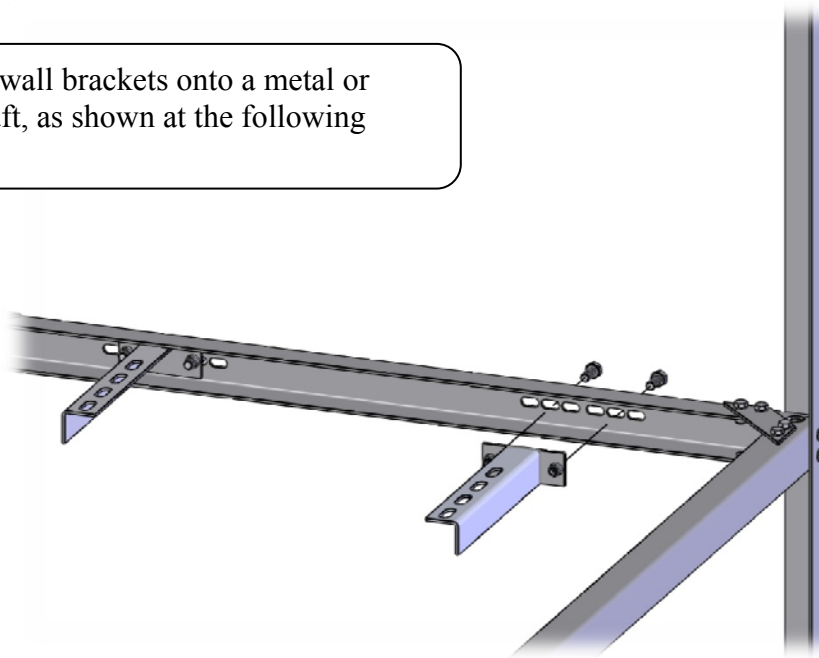

Step 2

Mount the guide brackets for the sling and the counterweight opposite each other in pairs for every wall bracket.

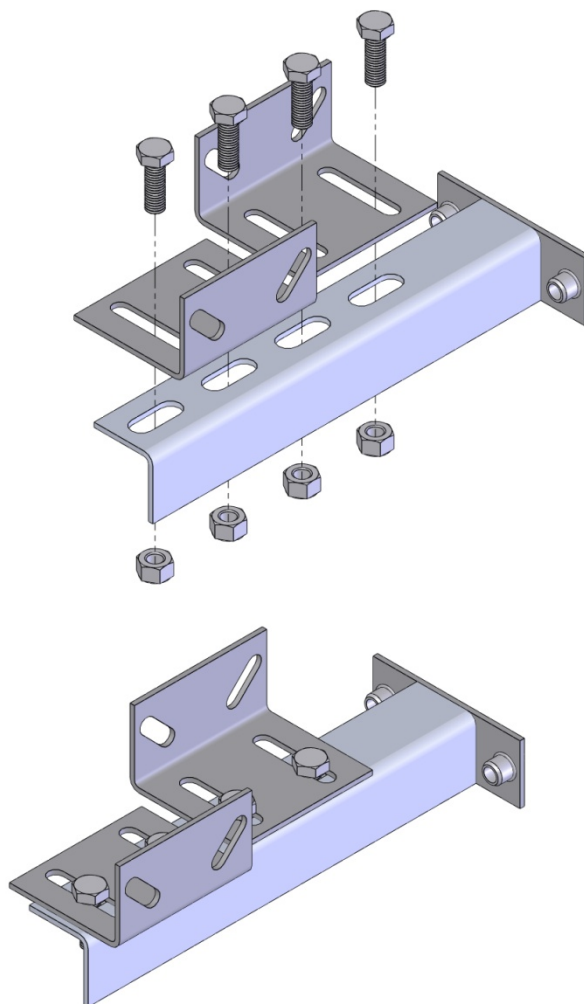

Step 3

Install the T50X50X5 (2,5m) guides as shown to the picture, by adding to the bottom side any additional guide pieces.

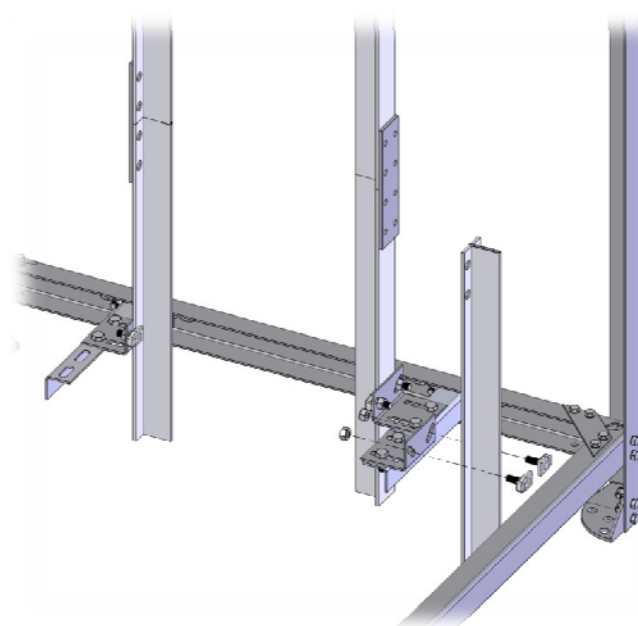

C. MOTOR INSTALLATION**Step 1**

Mount the motor base brackets, as shown in the pictures.

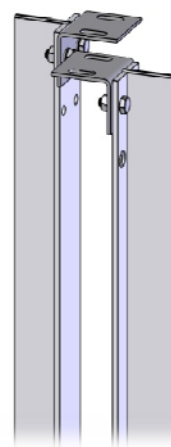
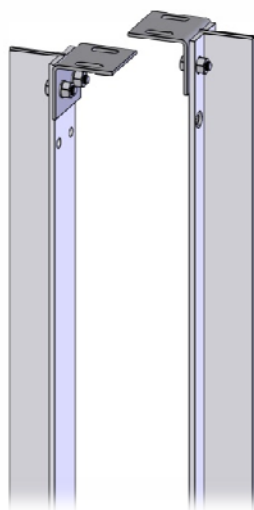
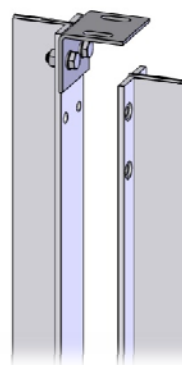
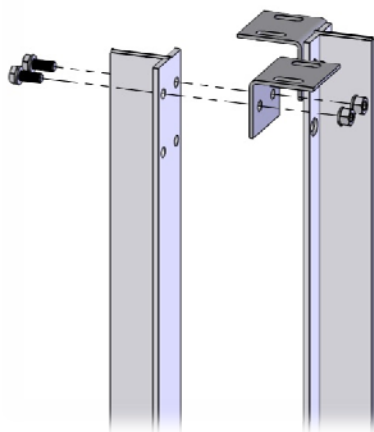

Step 2

Mount the motor **hangers** to the motor base as shown in the picture and place it on the guides.

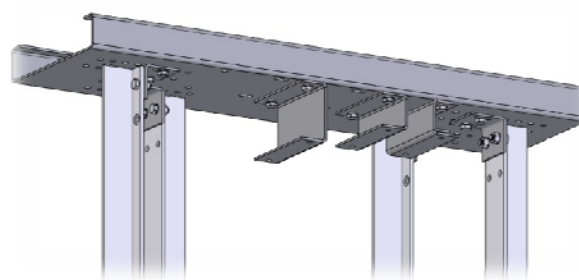
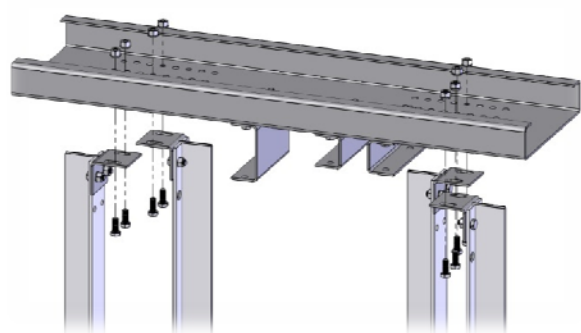
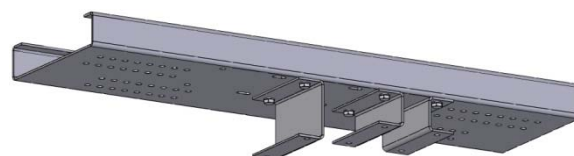
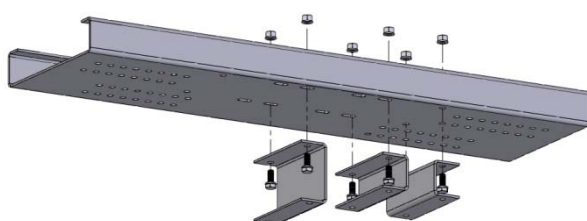

Step 3

Assemble the motor shaft, the pulley and the pillow block to the motor and hang the whole motor to its motor base, as shown to the following pictures.

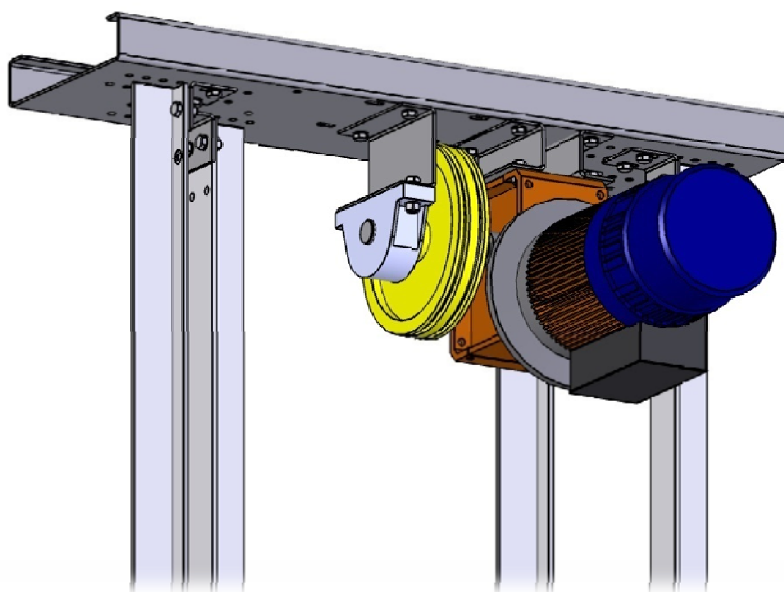
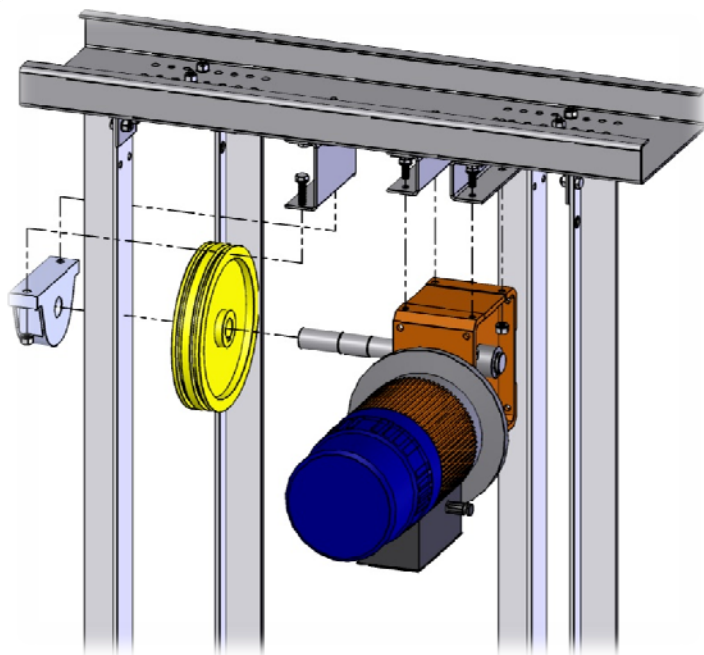

D. COUNTERWEIGHT INSTALLATION**Step 1**

Fix the counterweight sling sides to the guides and assemble the upper and bottom beams.

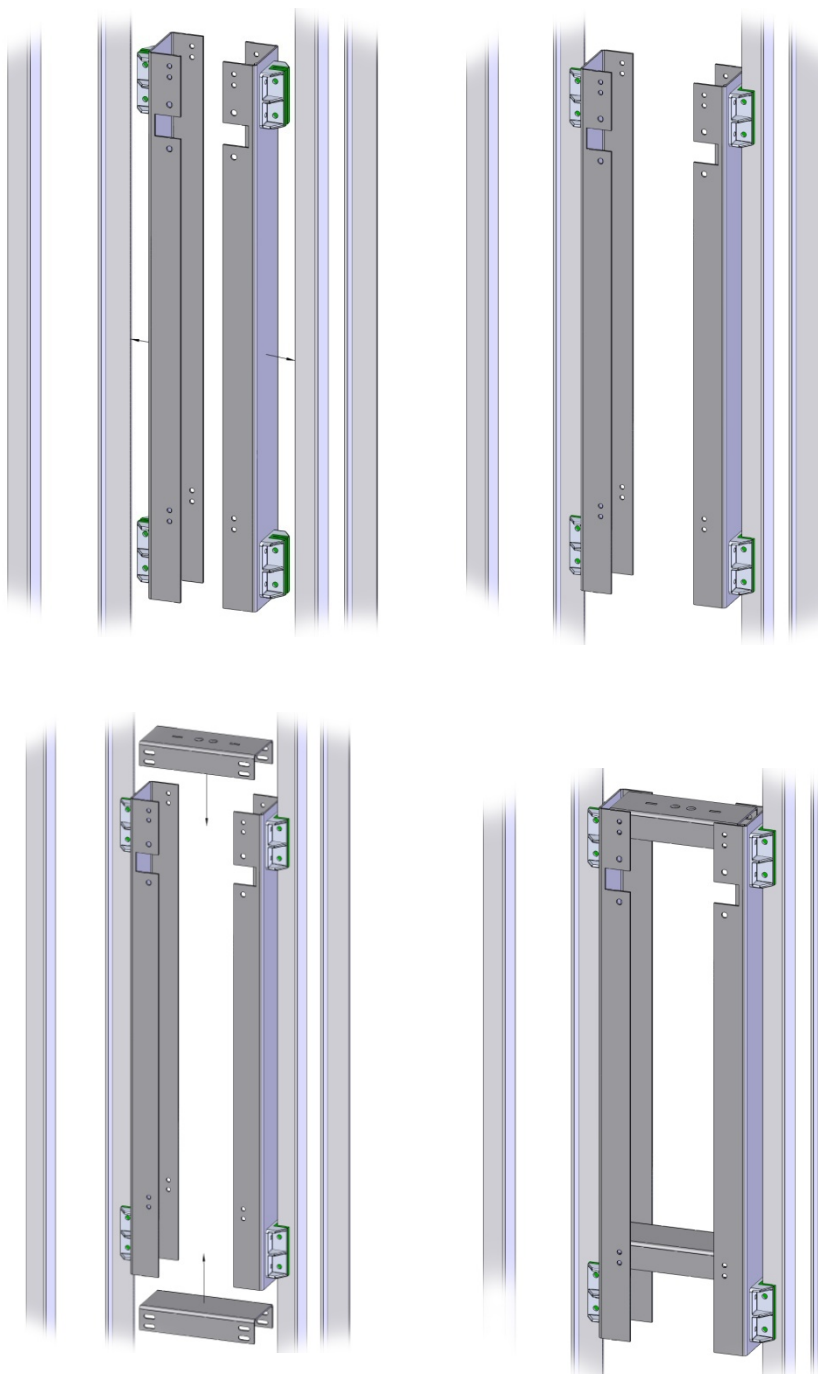

Step 2

Place the counterweights inside the sling.

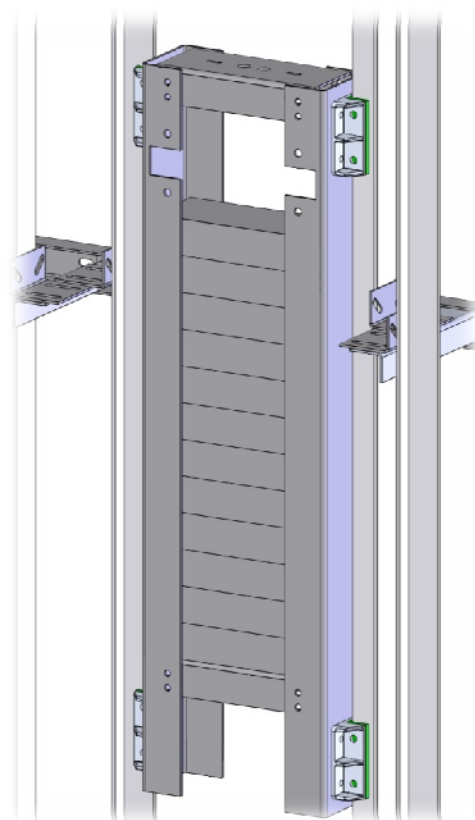
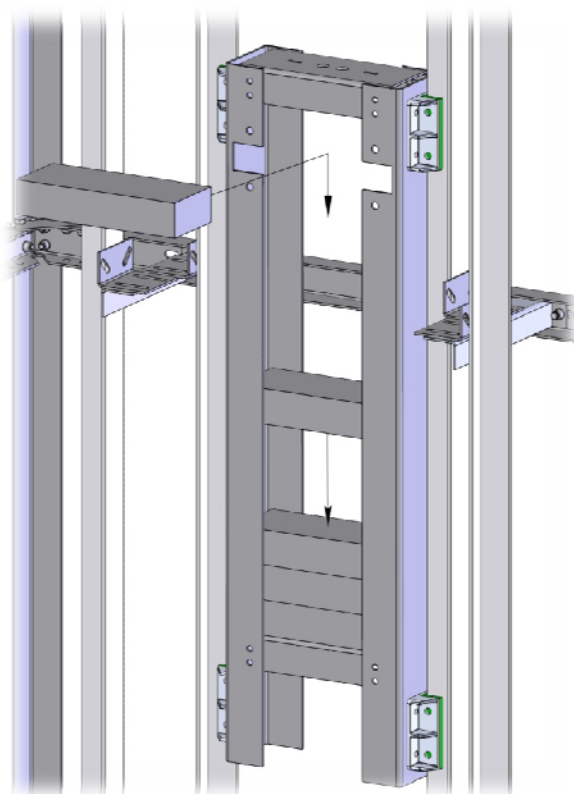

E. CAR SLING INSTALLATION**Step 1**

Assemble the sling side with the shoes and the fork of the sling. Next, mount the magnet's base and the additional car suspension flange, as shown in the picture.

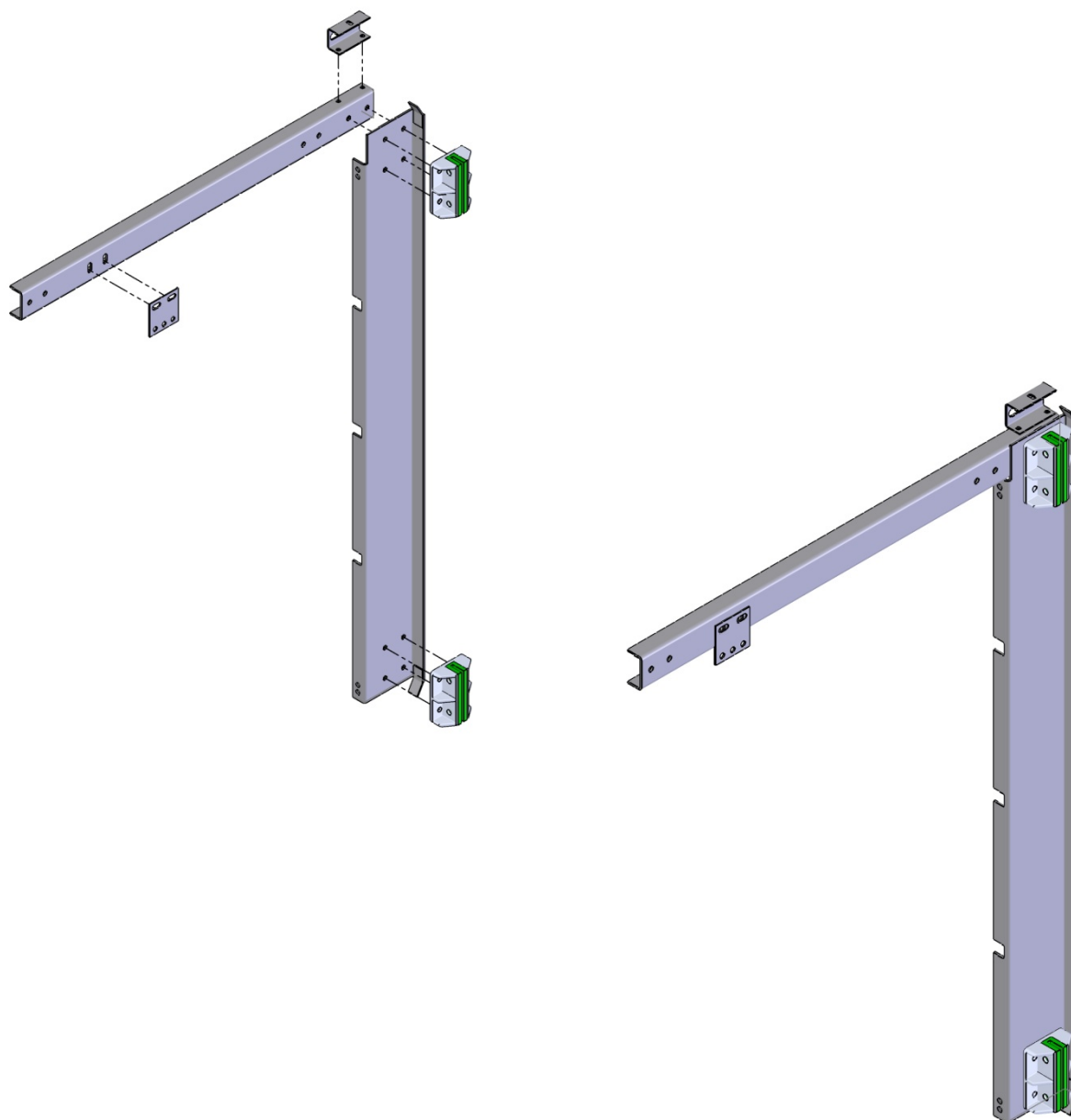

Step 2

Assemble the sling sides with the cross beams, by mounting them at the same time on the guides. The sling suspension beam is placed on the guides' side.

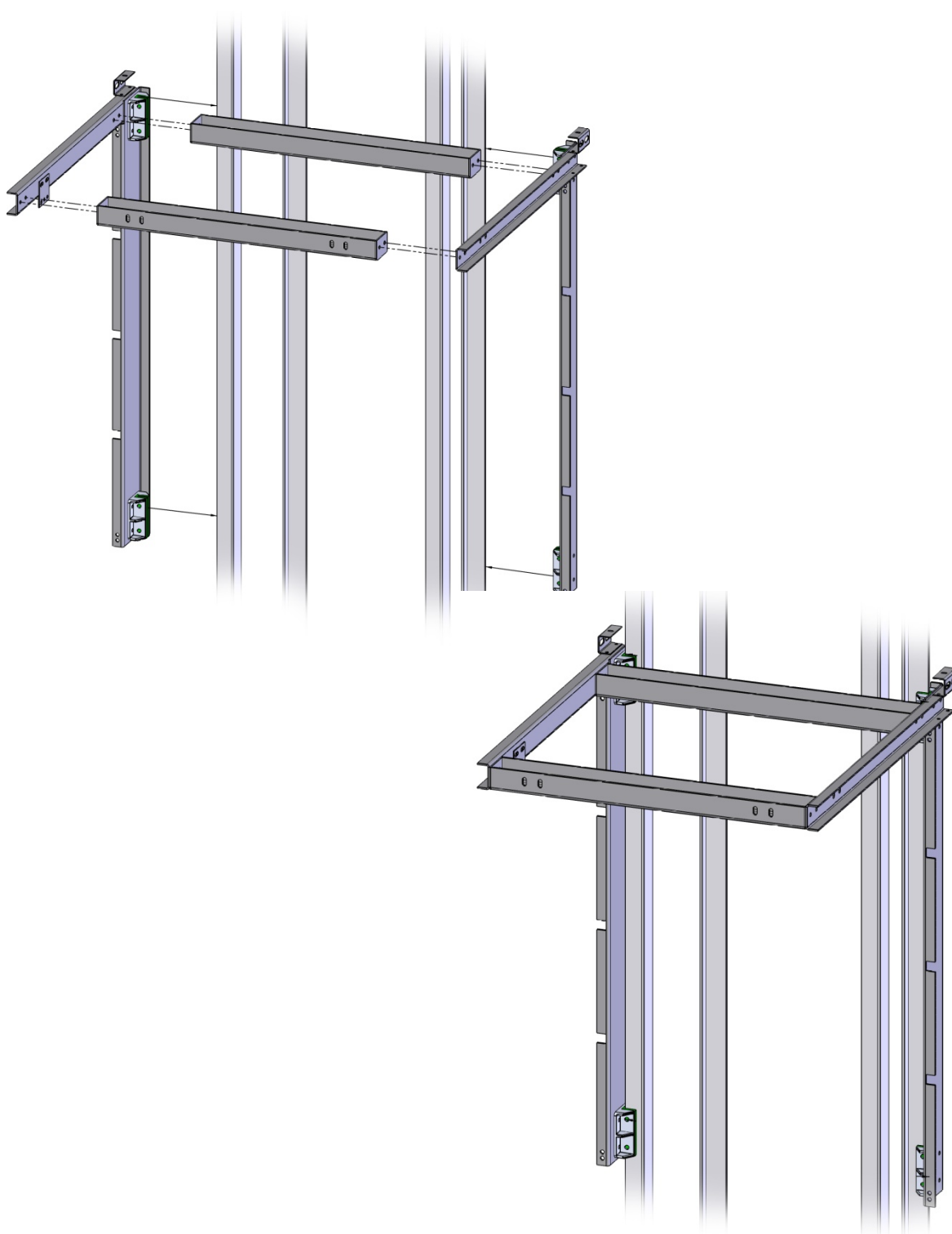

F. CAR INSTALLATION

Fix the car to the car sling, as shown in the pictures, by using the bolts **that fix the car sides**. Next, mount the car roof with 4 M8 bolts.

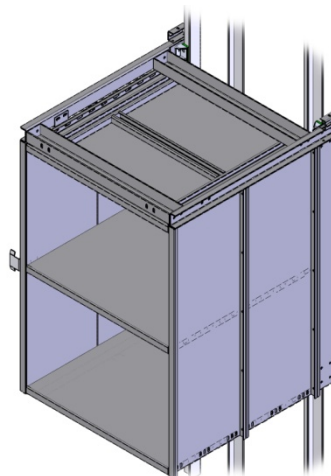
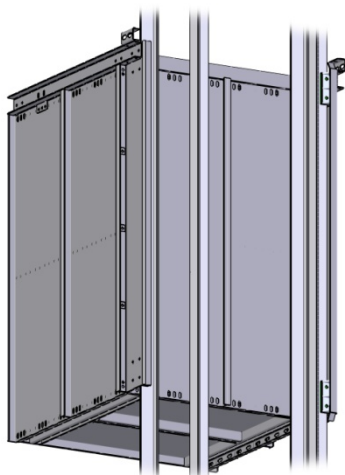
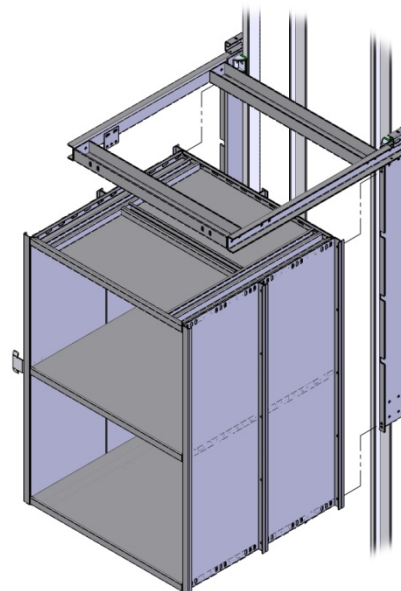
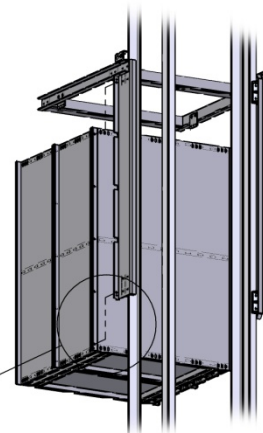
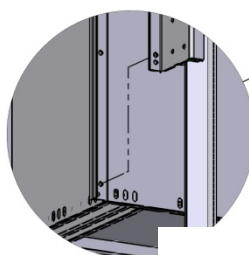
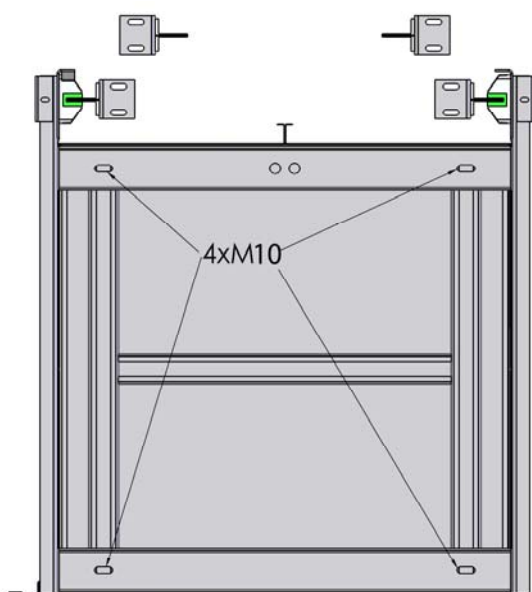

G. DOOR INSTALLATION

Fix the door to the upper and bottom brackets, as shown in the pictures.

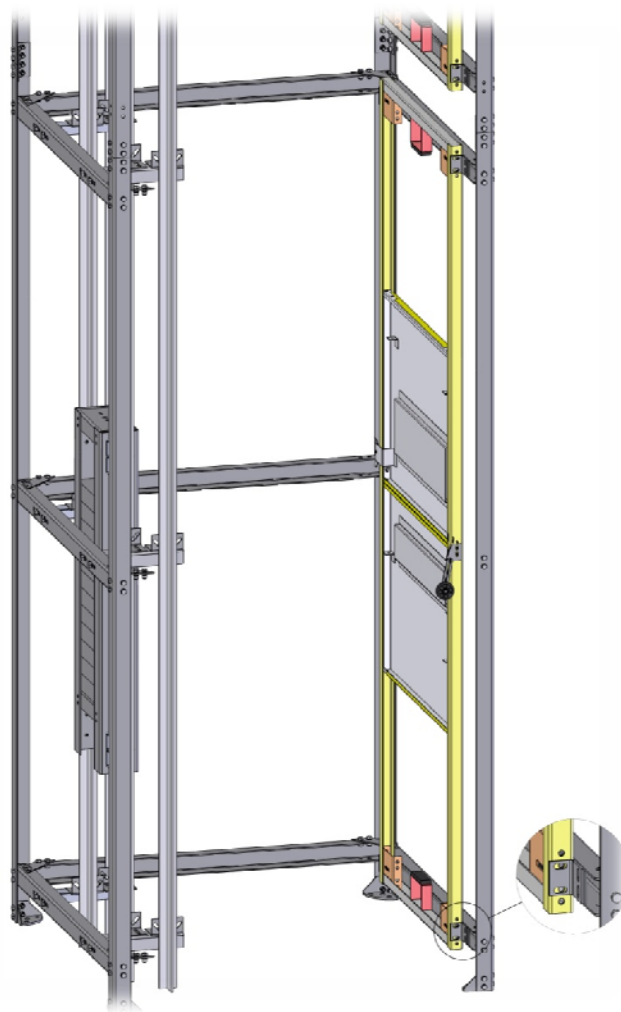
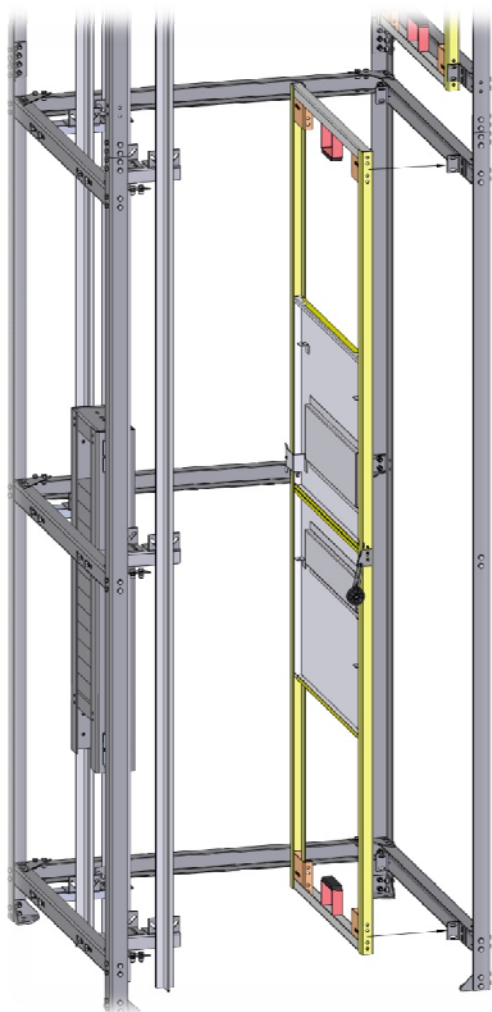

Mount the wheel with the bracket on the lock and adjust with the nuts.

